



Knight's Armament Company

701 Columbia Blvd.

Titusville, FL 32780

Phone (321) 607-9900 * Fax (321) 383-2143

ISO 9001 CERTIFIED ORGANIZATION



Certificate No: 13261

Cage Code: 1S002, DUNS No.05-403-8183, TIN: 59-1230657

On the web at: knightarmco.com

*When your life is on the line
...only the finest will do.*

M14 Rifle RAS Installation Instructions

Assy. P/N: 22121 (Complete with Rear Base P/N: 23097)

And P/N: 22121-1 (Without Rear Base)



Rear Base (23097)
Not part of 22121-1

9-Rib Panels (P/N: 97169) 2 ea.

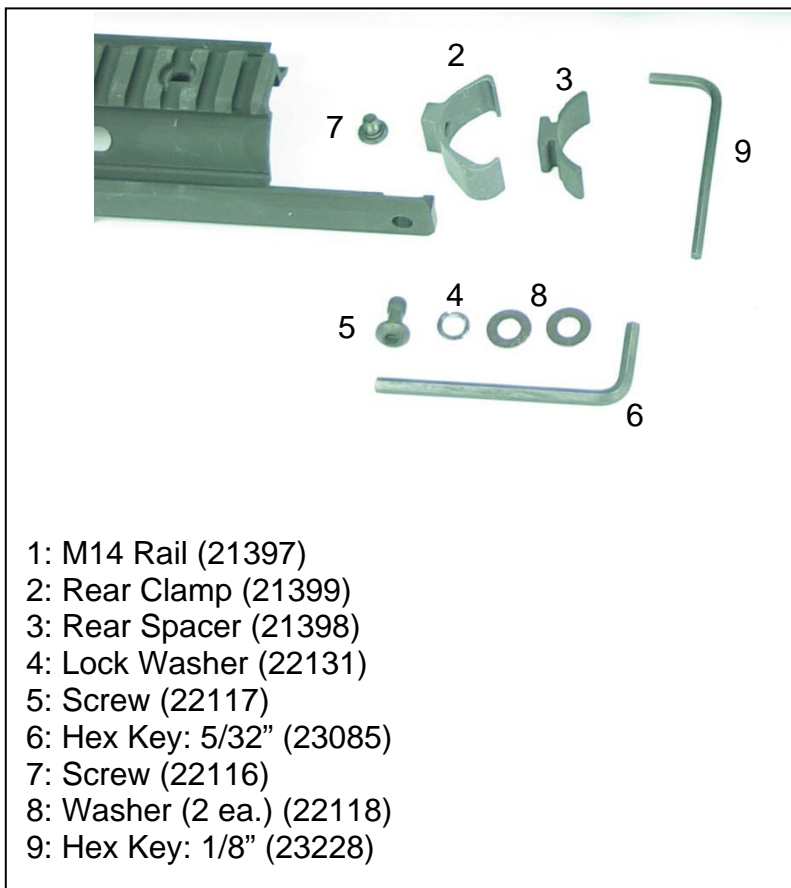

- 1: M14 Rail (21397)
- 2: Rear Clamp (21399)
- 3: Rear Spacer (21398)
- 4: Lock Washer (22131)
- 5: Screw (22117)
- 6: Hex Key: 5/32" (23085)
- 7: Screw (22116)
- 8: Washer (2 ea.) (22118)
- 9: Hex Key: 1/8" (23228)

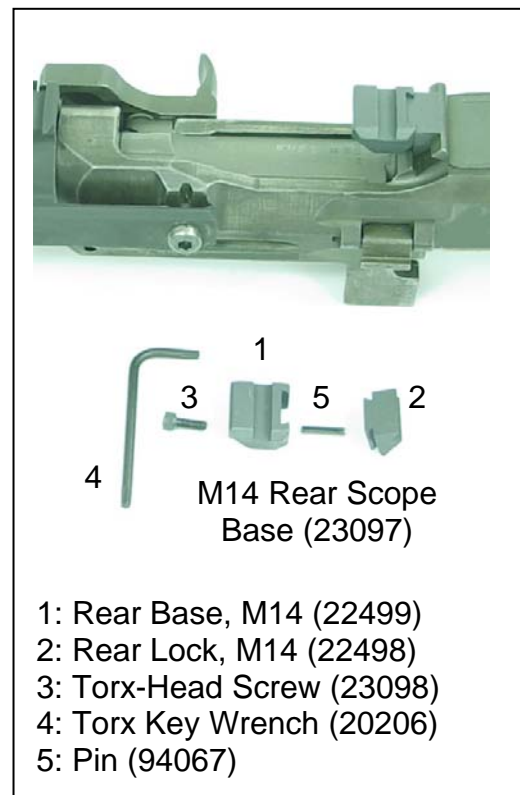

- M14 Rear Scope Base (23097)
- 1: Rear Base, M14 (22499)
 - 2: Rear Lock, M14 (22498)
 - 3: Torx-Head Screw (23098)
 - 4: Torx Key Wrench (20206)
 - 5: Pin (94067)

1. Before installation, remove Top Rail Allen Screw with a 1/8" Allen Wrench.



Note: these pictures may not represent the final production version of this assembly

2. Insert the RAS's Front Spacer Spring under the top edge of the rifle's forward handguard cap, and lower the rear of the RAS down towards the barrel.

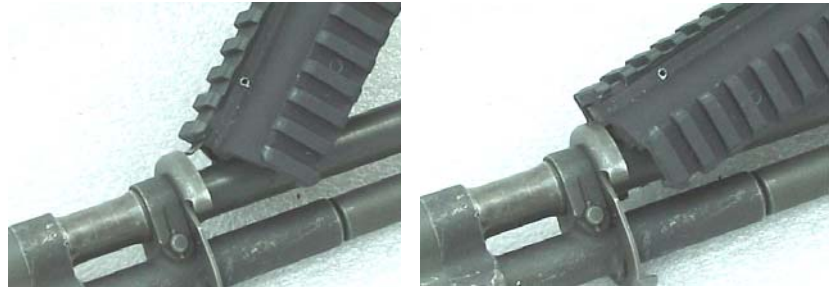

3. Note correct orientation of Rear Spacer & Rear Clamp as the RAS is lowered to the barrel.

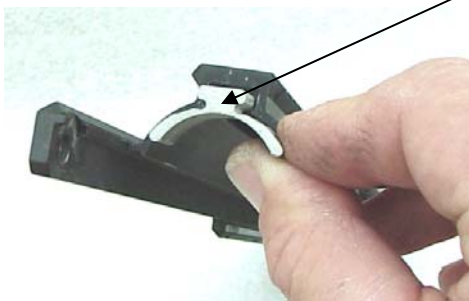

The Rear Spacer fits into the "T" Slot



The Rear Clamp fits into the barrel grooves

As the RAS is lowered to the barrel, the Rear Spacer and Clamp must be positioned as shown—with the Spacer poised behind the Clamp.

The hole in the Rear Clamp must also align with the passage hole in the top rail for the Top Screw.



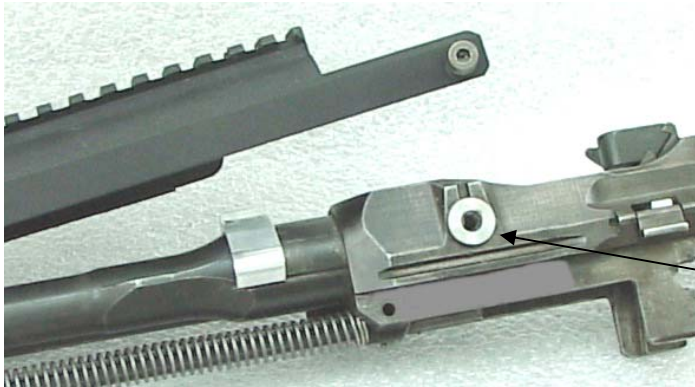

4. Carefully lower the rear of RAS onto barrel.

Note location of Side Screw Spacers

5. Partially tighten Side Screw and then the top Screw. Once the parts come into alignment, tighten them "medium tight".

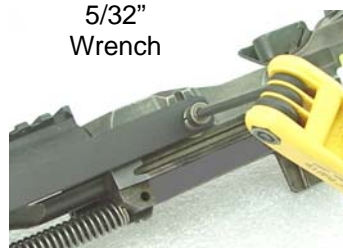

5/32" Wrench

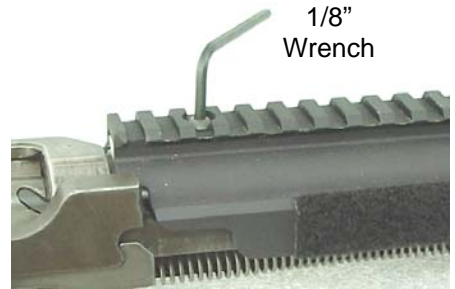

1/8" Wrench

6. Optional: Rear Scope Ring Rail replaces Charger Guide

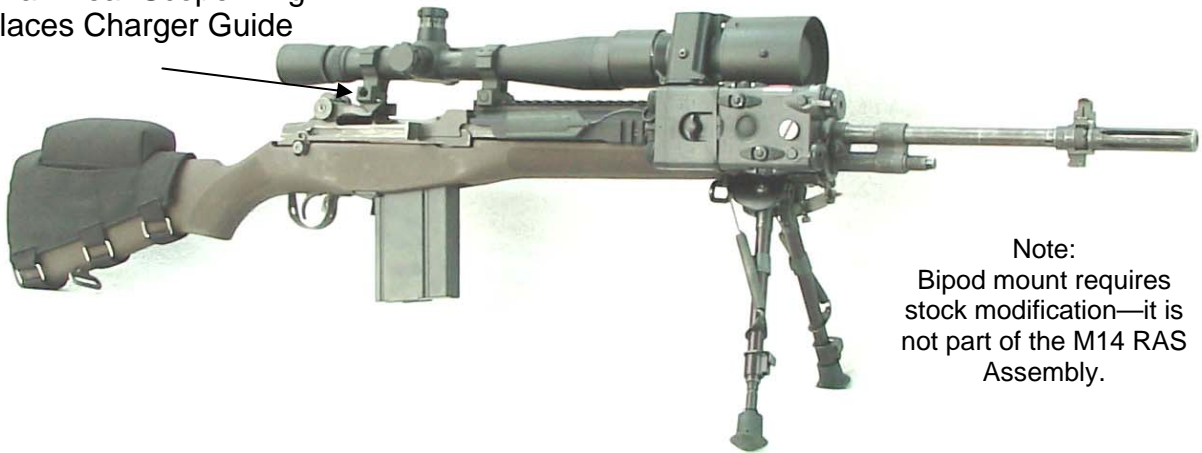

Note:
Bipod mount requires stock modification—it is not part of the M14 RAS Assembly.



6. Install Handguard panels with their latches pointed towards the muzzle as shown here.

Note:
Handguard panels (if used) should be positioned rearwards to where your forehead normally grasps the rifle, but not so as to interfere with rifle operating rod's forward position.

Rear Scope Base Installation Instructions

1. Remove original M14 Charger Guide from receiver cross-dovetail.
2. Slide rear lock (#2) into M14 receiver cross-dovetail and center it with roll pin hole in receiver with an undersize drift punch.
3. Using a roll pin holder as shown, partially drive new Pin (#5). Complete pin installation with a correct diameter drift punch.
4. Slide rear base (#1) onto installed lock and loosely install TORX head screw (#3).
5. Using a straight edge, bring top surface of rear base to same height as forend rail.
6. Tighten screw with TORX wrench (size T-15) provided. Installation is now complete.



1. Align rear lock.



2. Start roll pin.



3. Drive roll pin flush.

4. Install rear base.
5. Align top rail surfaces.

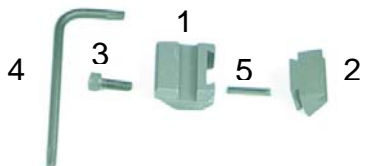
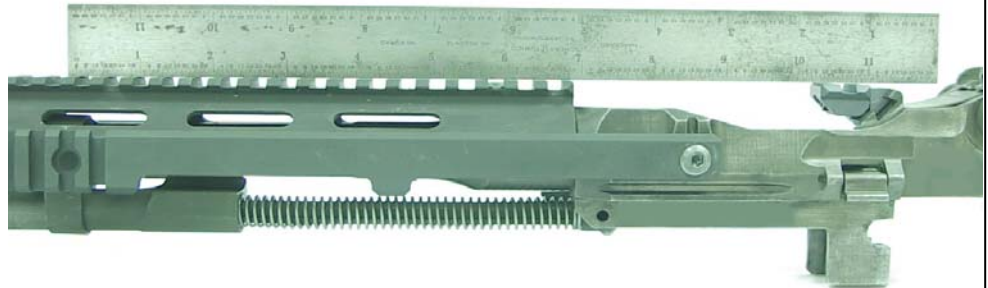

- 1: Rear Base, M14 (22499)
- 2: Rear Lock, M14 (22498)
- 3: Torx-Head Screw (23098)
- 4: Torx Key Wrench (20206)
- 5: Pin (94067)



6. Tighten screw.